

THIS DOCUMENT IS THE PROPERTY OF
KEYSTONE ELECTRONICS CORP. AND
SHALL NOT BE REPRODUCED, DISTRIBUTED
OR USED AS A BASIS FOR MANUFACTURE
WITHOUT PRIOR WRITTEN PERMISSION
FROM KEYSTONE ELECTRONICS CORP.

APPROVED BY:
Signed _____
Company _____ Date: _____

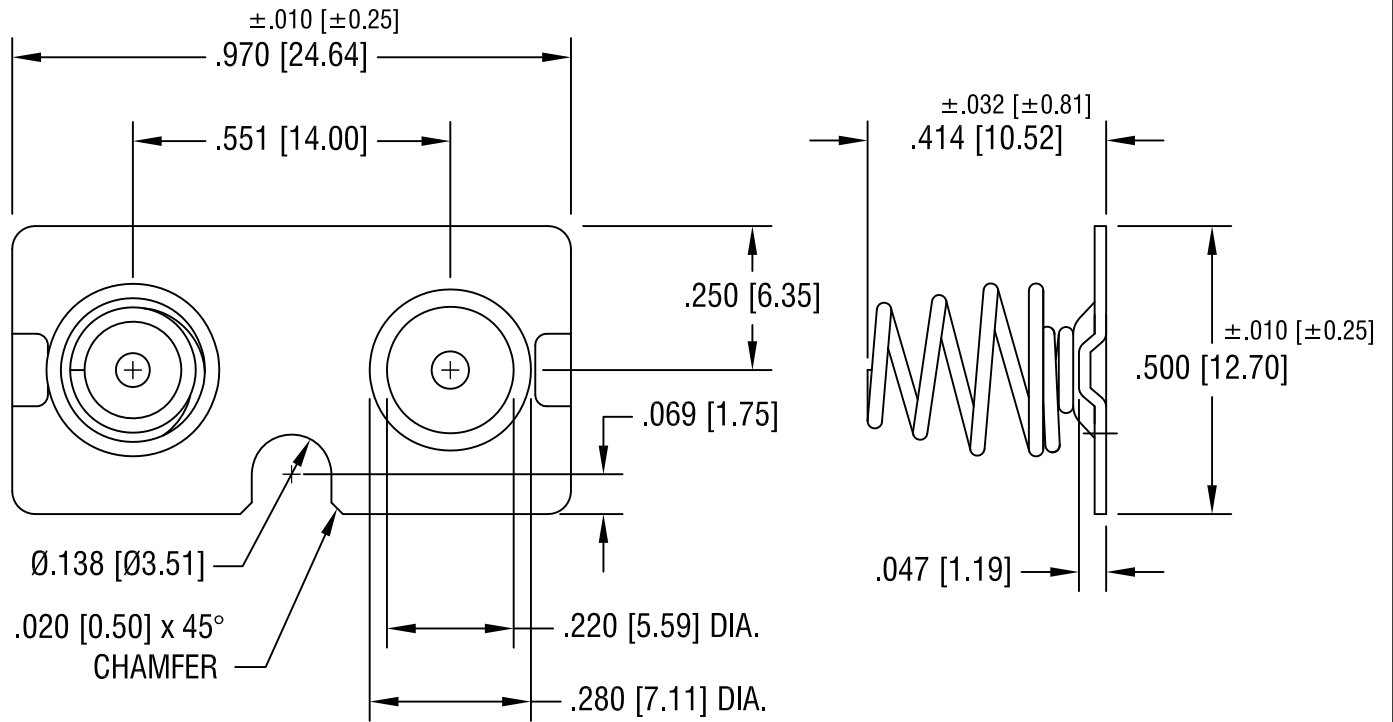

NOTES:

1. BASE:

MAT'L - .020 [0.50] TH'K STEEL

SPRING CONTACT:

MAT'L - .023 [0.58] DIA. MUSIC WIRE

KEYSTONE ELECTRONICS CORP.

www.keyelco.com • ASTORIA, N.Y. 11105-2017 • Tel (718) 956-8900

PART NAME

'AA' DUAL M/F BATTERY CONTACT

MATERIAL

AS NOTED

FINISH

NICKEL PLATE

DRN BY

NT

DATE

12.07.10

APP'D

SCALE

3X

05/20/11

.069 [1.75] WAS .059 [1.50]
ADD .02 [0.5] x 45° CHAMFER

.138 [3.5] was .236 [6.0]

A

TOLERANCES

INCH [MM]

DECIMAL ± .005 [± 0.13]

ANGULAR ± 1°
UNLESS OTHERWISE SPECIFIED

CODE

C/M

DWG NO.

9-5212-SLT

DATE

DESCRIPTION

REV.