

THIS DOCUMENT IS THE PROPERTY OF KEYSTONE ELECTRONICS CORP. AND SHALL NOT BE REPRODUCED, DISTRIBUTED OR USED AS A BASIS FOR MANUFACTURE WITHOUT PRIOR WRITTEN PERMISSION FROM KEYSTONE ELECTRONICS CORP.

MOUNTING DETAIL

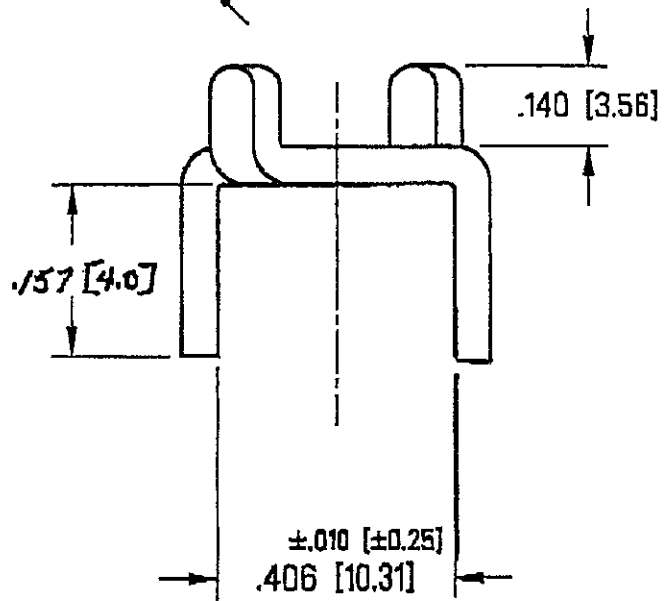
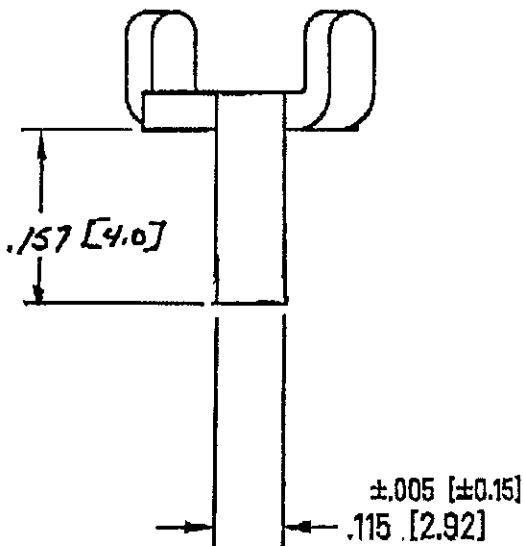
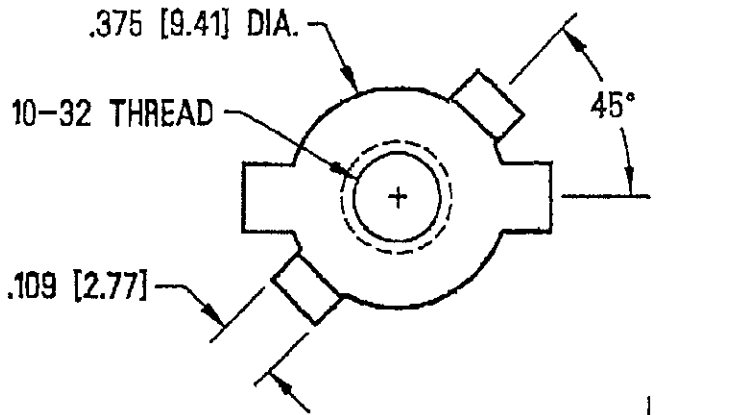
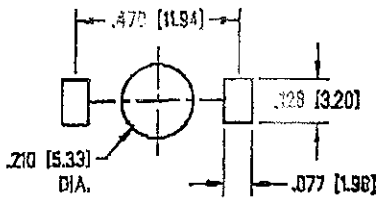

KEYSTONE ELECTRONICS CORP. ASTORIA, N.Y. 11105-2017			
PART NAME SCREW TERMINAL			
MATERIAL .064 [1.63] TH'K BRASS			
FINISH TIN PLATE		DRN BY BOONE	DATE 7.1.99
		APP'D <i>[Signature]</i>	SCALE 3X
TOLERANCES DECIMAL ANGULAR ± 2° UNLESS OTHERWISE SPECIFIED	INCH ±.015 [±.38]	MM	CODE C/M
		DWG NO. 9-1208-157	

DATE	DESCRIPTION	REV.