

DATE	DESCRIPTION	REV.

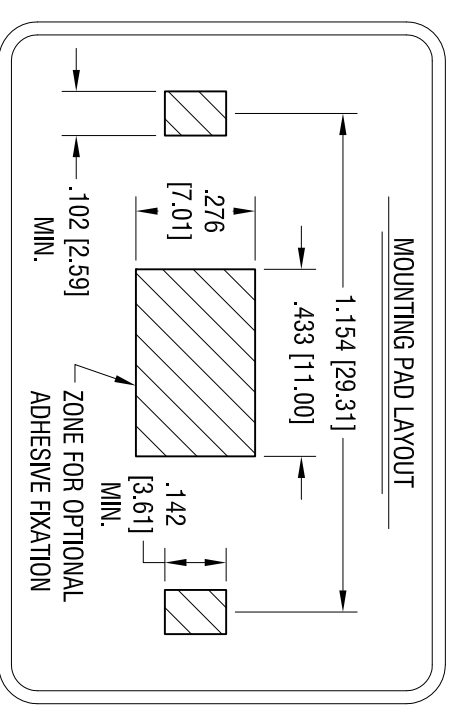

**NOTES:**

- 1. BASE:  
MAT'L - GLASS FILLED LCP UL 94V-0
- 2. CONTACTS:  
MAT'L - .006 [0.15] THK PHOSPHOR BRONZE  
FINISH: TIN PLATING

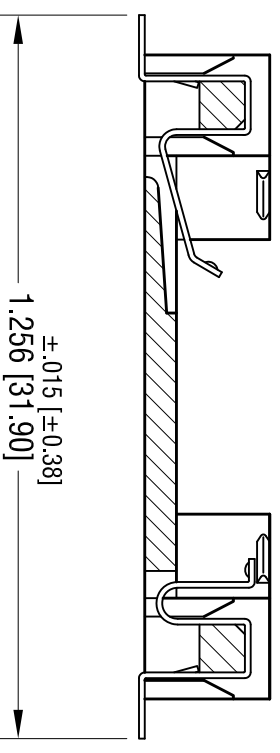
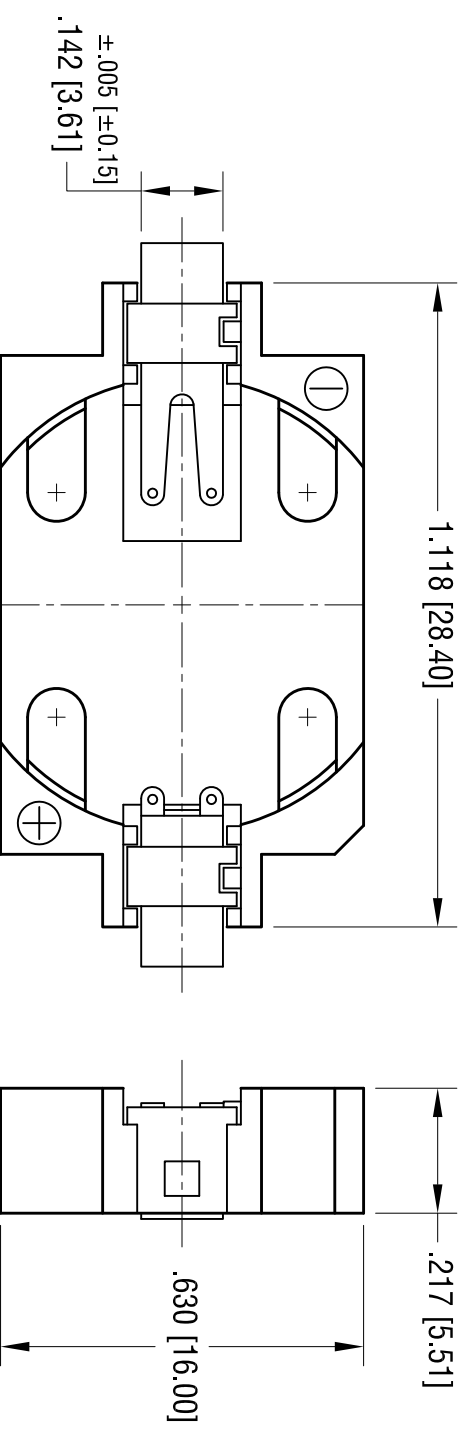
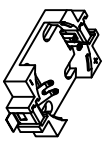

**ACTUAL SIZE**

THIS DOCUMENT IS THE PROPERTY OF KEYSTONE ELECTRONICS CORP. AND SHALL NOT BE REPRODUCED, DISTRIBUTED OR USED AS A BASIS FOR MANUFACTURE WITHOUT PRIOR WRITTEN PERMISSION FROM KEYSTONE ELECTRONICS CORP.

<b>KEYSTONE ELECTRONICS CORP.</b>			
www.keystec.com • ASTORIA, N.Y. 11105-2017 • Tel (718) 956-8900			
PART NAME			
2032 BATTERY HOLDER, SMT			
MATERIAL			
AS NOTED			
FINISH		AS NOTED	
TOLERANCES	INCH	[MM]	CODE
DECIMAL	± .010	[± 0.25 ]	C
ANGULAR	± 1°		
UNLESS OTHERWISE SPECIFIED			
DRN BY	DATE	DWG NO.	SCALE
AppD	LN	LN	3X
1.06.16			
9-1060-TP			