

THIS DOCUMENT IS THE PROPERTY OF  
KEYSTONE ELECTRONICS CORP. AND  
SHALL NOT BE REPRODUCED, DISTRIBUTED  
OR USED AS A BASIS FOR MANUFACTURE  
WITHOUT PRIOR WRITTEN PERMISSION  
FROM KEYSTONE ELECTRONICS CORP.

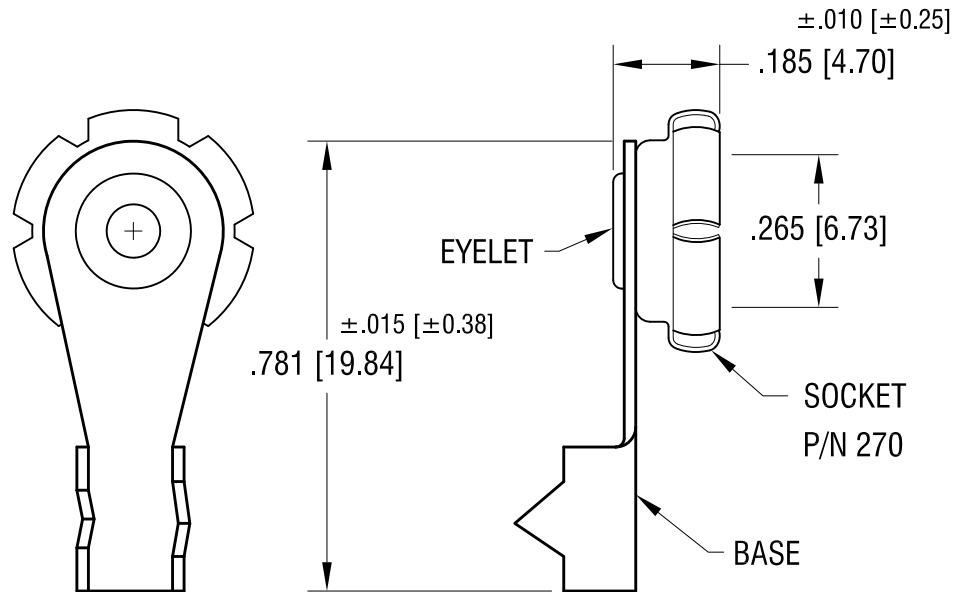

**NOTE:**

1. BASE - MAT'L: .020 [0.51] THK BRASS  
FINISH: MATTE TIN PLATE
2. SOCKET - MAT'L: BRASS  
FINISH: NICKEL PLATE
3. EYELET - MAT'L: BRASS  
FINISH: TIN PLATE

<b>KEYSTONE ELECTRONICS CORP.</b>			
www.keyelco.com • ASTORIA, N.Y. 11105-2017 • Tel (718) 956-8900			
PART NAME		SENIOR SOCKET PC SNAP-ON	
MATERIAL		AS NOTED	
FINISH	AS NOTED	DRN BY	BOONE
		APP'D	LN
		DATE	2.10.82
		SCALE	3X
TOLERANCES	INCH [MM]	CODE	DWG NO.
DECIMAL	$\pm .005 [\pm 0.15]$	C/M	
ANGULAR	$\pm 1^\circ$		
UNLESS OTHERWISE SPECIFIED			<b>272</b>

11.24.09	CHANGE AS PER ECN 09-173	C
12.21.05	CHANGE AS PER ECN 05-091	B
DATE	DESCRIPTION	REV.