

# PC SCREW TERMINALS

## LOW PROFILE VERTICAL TYPE

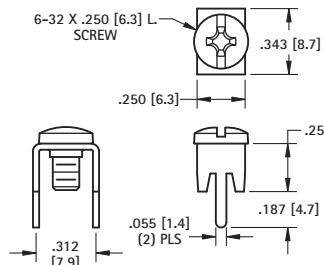

- Color coded screws available (add color screw suffix to Cat. No.)

**CAT. NO. 7784** (No Screw Supplied)

**CAT. NO. 8198** (Screw Supplied Unassembled)

**CAT. NO. 7778** (Screw Installed & Captivated)

### Mounting Detail

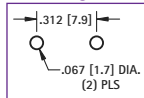

### SPECIFICATIONS

**Rated:** 15 Amps  
**Terminal:** .032 (.81) Brass, Matte Tin Plate  
**Binding Head Screw:** Brass, Nickel Plate

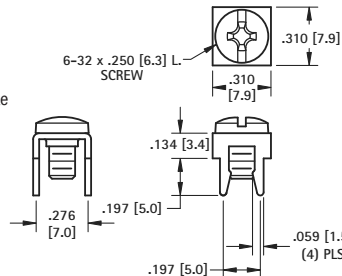

7775-2

- Color coded screws available (add color screw suffix to Cat. No.)

### Mounting Detail

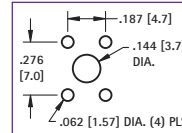

**CAT. NO. 7785** (No Screw Supplied)

**CAT. NO. 8195** (Screw Supplied Unassembled)

**CAT. NO. 7775** (Screw Installed & Captivated)

## VERTICAL TYPE

### EXTENDED



7699-6

### PC MOUNT

- Color coded screws available (add color screw suffix to Cat. No.)

**CAT. NO. 7789** (No Screw Supplied)

**CAT. NO. 7697** (Screw Supplied Unassembled)

**CAT. NO. 7699** (Screw Installed & Captivated)

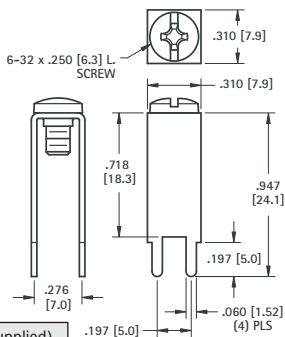

### SPECIFICATIONS

**Rated:** 15 Amps  
**Terminal:** .032 (.81) Brass, Matte Tin Plate  
**Binding Head Screw:** Brass, Nickel Plate

### Mounting Detail

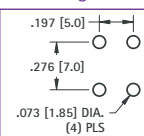

### HEAVY DUTY



8174

### Mounting Detail

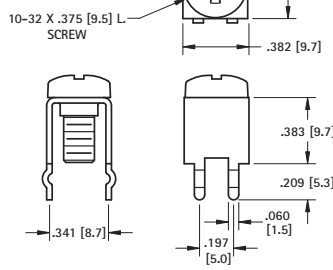
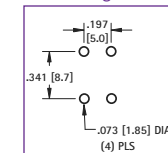

**CAT. NO. 7791** (No Screw Supplied)

**CAT. NO. 8174** (Screw Supplied Unassembled)

## 30 AMP - HEAVY DUTY

### HORIZONTAL

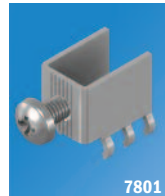

7801

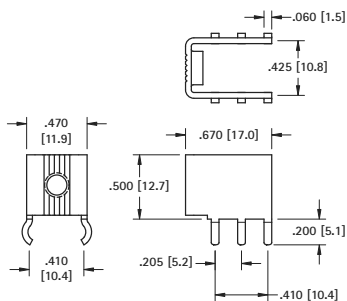

### SPECIFICATIONS

**Rated:** 30 Amps  
**Terminal:** .045 (1.14) Brass, Matte Tin Plate  
**Screw:** Stainless Steel

### Mounting Detail

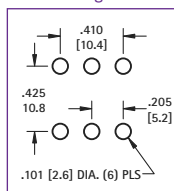

### VERTICAL



8196

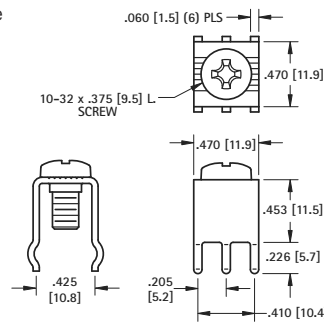

**CAT. NO. 7787** (No Screw Supplied)

**CAT. NO. 8196** (Screw Supplied Unassembled)

## 30 AMP



8199-6

- Color coded screws available (add color screw suffix to Cat. No.)

### SPECIFICATIONS

**Rated:** 30 Amps  
**Terminal:** .032 (.81) Brass, Matte Tin Plate  
**Binding Head Screw:** Brass, Nickel Plate

**CAT. NO. 7786** (No Screw Supplied)

**CAT. NO. 8197** (Screw Supplied Unassembled)

**CAT. NO. 8199** (Screw Installed & Captivated)

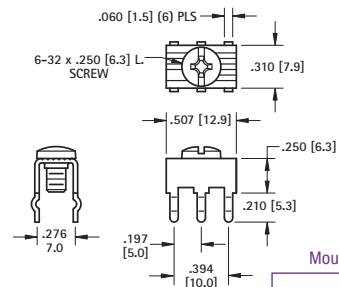

### Mounting Detail

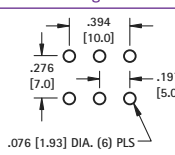

## COLOR CODED GUIDE

**CAT. NO. COLOR SUFFIX**  
 Ex: XXXX -X

**COLOR SELECTION:**  
 Select desired screw terminal and add color suffix to the screw terminal Cat. No.

HEAD COLOR	SUFFIX
RED	-2
BLACK	-3
WHITE	-4
BLUE	-5
GREEN	-6
YELLOW	-7
NICKEL	none

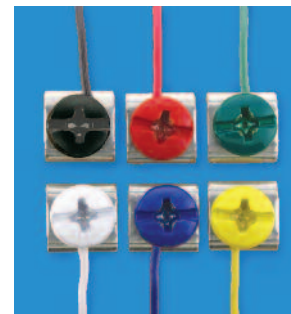

Refer to page 69 for color screws only